

# DID YOU KNOW?

about our...



**NEW  
PRODUCT**

## SEMS Hex Bolt with Spring and Flat Washer

### SEMS HEX BOLT WITH SPRING AND FLAT WASHER ZINC YELLOW PASSIVATE / GB 9074.17 / CLASS 8.8

| Part             | Nominal Size | Length | Thread Length | Head Height | Washer Diameter     | Washer Thickness    | Spring Washer Diameter | Spring Washer Thickness | Across Flats |
|------------------|--------------|--------|---------------|-------------|---------------------|---------------------|------------------------|-------------------------|--------------|
|                  | D (mm)       | L (mm) | T (mm)        | H (mm)      | D <sub>w</sub> (mm) | H <sub>w</sub> (mm) | D <sub>s</sub> (mm)    | H <sub>s</sub> (mm)     | AF (mm)      |
| LSMS88YHDCM08016 | M8           | 16     | Full          | 5.3         | 16                  | 1.6                 | 14.8                   | 2                       | 12           |
| LSMS88YHDCM08020 | M8           | 20     | Full          | 5.3         | 16                  | 1.6                 | 14.8                   | 2                       | 12           |
| LSMS88YHDCM08025 | M8           | 25     | Full          | 5.3         | 16                  | 1.6                 | 14.8                   | 2                       | 12           |
| LSMS88YHDCM08030 | M8           | 30     | Full          | 5.3         | 16                  | 1.6                 | 14.8                   | 2                       | 12           |
| LSMS88YHDCM08040 | M8           | 40     | Full          | 5.3         | 16                  | 1.6                 | 14.8                   | 2                       | 12           |
| LSMS88YHDCM08050 | M8           | 50     | Full          | 5.3         | 16                  | 1.6                 | 14.8                   | 2                       | 12           |

#### APPLICATIONS

- Automotive, electrical and telecommunications industries
- Automotive applications such as interior panels, front quarter panels, side panels and aftermarket accessories
- For use by auto electricians

#### FEATURES

- Includes spring and flat washers for ease of installation
- Options for easier screw removal
- Incorporated spring and flat washers reduce installation time and assembly costs while increasing output

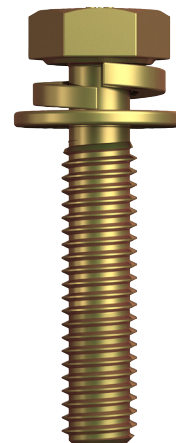
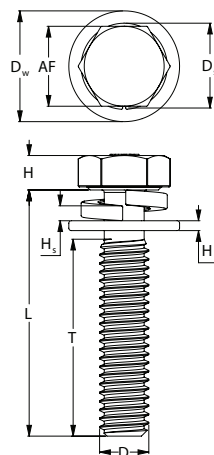

You can download this  
Test Certificate and/or  
Report from our website:  
**[hobson.com.au](http://hobson.com.au)**

Disclaimer: while every reasonable effort has been made to ensure that this document is correct at the time of printing, Hobson Engineering®, its agencies and employees disclaim all liability in respect to anything or the consequences of anything done or omitted regarding the whole or any part of this document. HEC product marking is the manufacturing mark of Hobson Engineering. HEC is a registered trademark of Hobson Engineering.

Bolt Tension | Anti-Vibration | Product Reliability | Traceability

**[hobson.com.au](http://hobson.com.au) QUALITY FASTENERS SINCE 1935**



2409031DYK